

**Head Office:**  
Dixon Kelley Estate Agents  
1 Penn Court  
Station Road, West Moors  
Dorset. BH22 0JJ

# DORSET PARK HOMES

**DRAFT**

[www.dorsetparkhomes.com](http://www.dorsetparkhomes.com)

**Telephone: 01202 877511**

**3 Hawthorn Avenue, Deers Court, Horton Road, Three Legged Cross, Wimborne. BH21 6FP**



**Quality Park Home on New Residential Park**

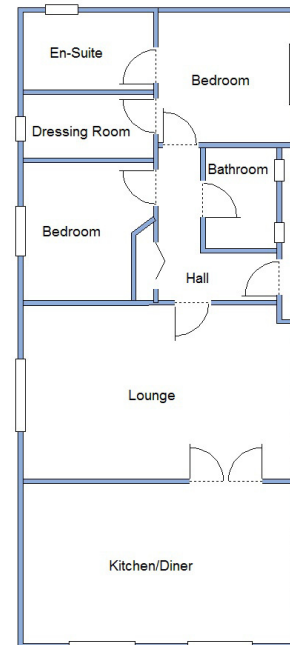

This drawing has been prepared for diagrammatic purpose only. Not to scale.

## 2-Bedroom Park Home - approx 46' x 20'

Accommodation & approximate room dimensions:

- Stately Albion 'Chartwell' 2019
- Hall: Cloaks cupboard housing gas combination boiler.
- Lounge: approx 19'2" x 12'4" max. Vaulted ceiling & feature fireplace. Double doors to:
- Kitchen/Diner: approx 19'2" x 11'4". Superb fitted kitchen with an excellent range of floor and wall cupboards. Built-in microwave oven & range style cooker with extractor over. Integrated dishwasher, washing machine & fridge/freezer. Vaulted ceiling with LED lighting. Double doors to Raised Deck.
- Bedroom 1: approx 9'7" x 9'5" Plus Dressing Room.
- Luxury En-Suite Shower Room
- Bedroom 2: approx 9'9" x 9'3". Fitted wardrobes.
- Bathroom: Double ended roll top bath. Wash basin & WC. Chrome heated towel rail.
- Gas Central Heating & PVCu Double-Glazing
- Small Garden with Metal Shed & 'On-Plot' Parking
- Age Restriction 45+ Pets Considered
- Gated, Developing Residential Park set in 34 acres of private country park.

## Immaculate Home with Field View



**Price: £260,000 Offers Over**

**Pitch Fee: approx £270 per cal month including water  
Subject to Annual Review  
Council Tax Band: 'A' Tenure: 1983 Mobile Homes Act Agreement**

**VIEWING STRICTLY BY APPOINTMENT WITH THE VENDOR'S AGENT Dorset Park Homes 01202 877511**

**IMPORTANT NOTE:** These particulars are believed to be correct but their accuracy is not guaranteed. They do not form part of any contract. Nothing in these particulars shall be deemed to be a statement that the property is in good structural condition or otherwise, nor that any of the services, appliances, equipment or facilities are in good working order or have been tested. Purchasers should satisfy themselves on such matters prior to purchase Ref.W04450

*The recommended specialist in Park Home sales*  
Proprietor: Simon Dixon

